



Gardena Valley Japanese Cultural Institute

Come See What's Inside

WHO WE ARE



The Gardena Valley Japanese Cultural Institute (GVJCI) is a 501(c)(3) nonprofit community center incorporated in 1967 but its roots began over a hundred years ago. We engage the community to explore the Nikkei heritage, culture, and contemporary issues through a variety of programs and services, and we invite the community to collaborate with us for new opportunities. Community space is offered to nonprofit cultural, educational and community-based organizations, as well as, private facility usage. Our affiliate nonprofit corporation, the Gardena Valley Japanese Cultural Institute Housing Project, provides affordable housing through the JCI Gardens Apartments, the adjacent senior housing property.

MISSION STATEMENT

A space to engage, share, and embrace the Nikkei experience and culture.

VISION STATEMENT

The GVJCI envisions a vibrant network and a welcoming space for all persons interested in Japanese heritage and culture where history and tradition are honored, people are inspired to create action and change, and cultural pride and respect for all humanity are promoted.

*Nikkei 日系

The first character 日 comes from the Chinese character for Sun, used to write out the proper kanji for Japan. The pronunciation of this Kanji varies between Nippon or Nihon, but the most commonly used pronunciation is Nihon. The second character 系 means descendants of or relation to. However, it can have multiple meanings as well.

The direct translation commonly used for Nikkei would be anyone of Japanese descent. Like so many words and phrases in Japan, it can have multiple meanings. This is probably the reason why there is no one true definition for the term Nikkei. However, we think this ambiguity allows for more peoples of Japanese descent (mixed-race, mixed-culture, and multiple generations) to embrace the term and unify the community.

As our community becomes more diverse, we would like to use the term Nikkei to welcome and embrace folks of varied walks of life to participate in our programs, events, and classes. In a similar movement to the Little Tokyo community, we will use the term Nikkei to create a vibrant and thriving community for all in the South Bay.



Who We Are



GARDENA VALLEY JAPANESE CULTURAL CENTER

1864

NISEI VETERANS MEMORIAL HALL

OUR FACILITIES

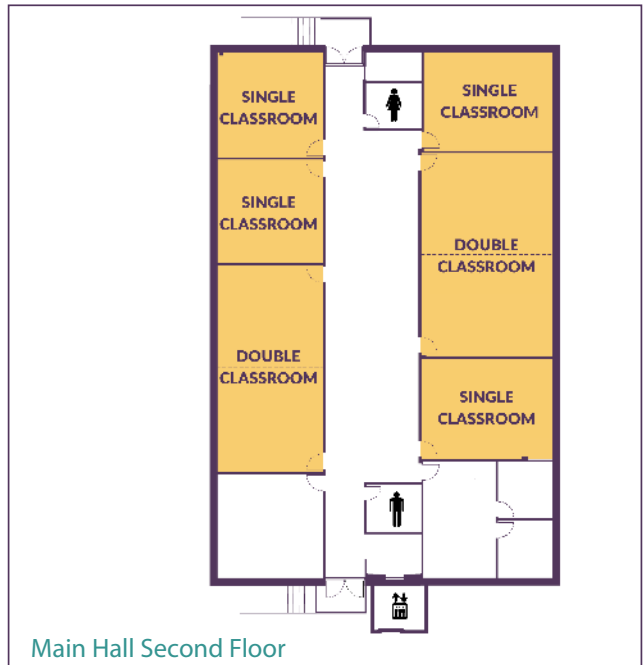
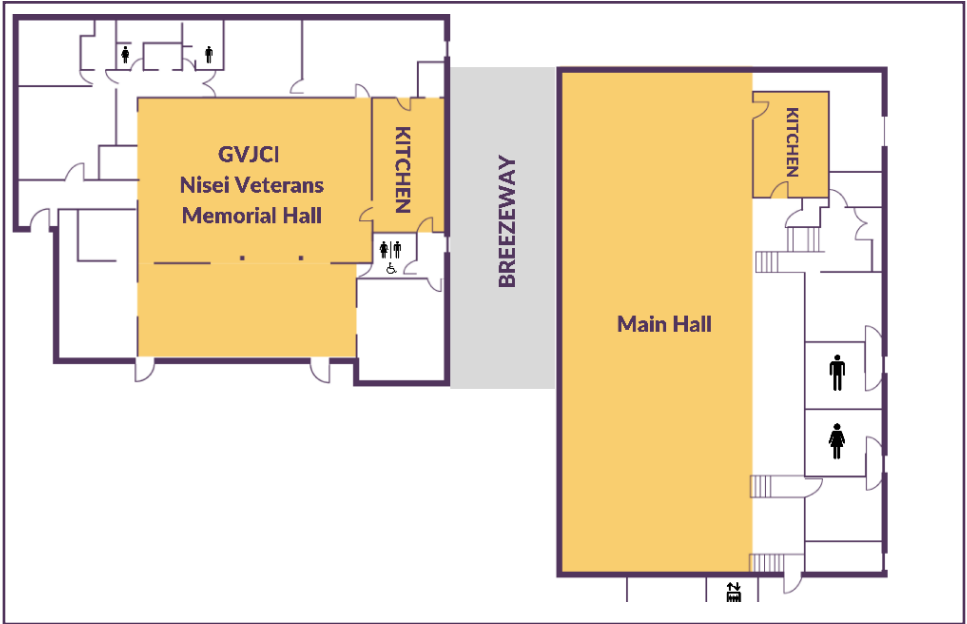

GVJCI MAIN HALL

Square Footage & Capacity:
Main Hall Hardwood Floor Area: 3600 sq ft
Tables & Chairs Capacity: 320 people
Chairs Only Capacity: 400 people

Features:

Dimmable Lighting
2 Projector Screens
5' Round Tables
8' Rectangular Tables
Chairs

Kitchen Featuring:

Stoves
Stainless Steel Counters & Sinks
Refridgerator & Freezer
Microwave Oven

Equipment Available for Rent:

Portable Stage up to 24' x 16'

Main Hall Events Have Included:

Wedding Receptions
Dances
Birthday Parties
Anniversary Parties
Luaus
Celebration of Life Services
Holiday Parties
Movie Screenings
Conferences and Lectures
Fundraising Events

CLASSROOMS

Capacity:

Single Classroom 25 person maximum
Double Classroom 50 person maximum

Features:

Chair/Desk Combo or Two Chair per Desk
8' x 4' White Board in each classroom

Equipment Available for Rent:

Portable Screen

Classroom Usage Have Included:

Instruction, study rooms
Movement, art, music classes
Workshops, seminars, trainings
Nonprofit organization, community, business meetings

GVJCI NISEI VETERANS MEMORIAL HALL

Square Footage & Capacity:
Square Footage: 2300 sq ft
Tables & Chairs Capacity: 150 people
Chairs Only Capacity: 200 people

Features:

Projector Screen
8' Tables
Chairs

Kitchen Featuring:

Stoves
Stainless Steel Counters & Sinks
Refridgerator & Freezer
Microwave Oven
Chairs

Equipment Available to Rent:

Portable Stage 12' x 8'
Portable PA System
Projector

GVJCI Nisei Veterans Memorial Hall Events

Have Included:
Birthday Parties
Anniversary Parties
Celebration of Life Services
Holiday Parties
Conferences and Lectures
Fundraising Events
Networking Social Events
Health and Financial Seminars

BREEZEWAY OUTDOOR SPACE

Square Footage: 1400 sq ft (70' x 20')

Equipment Available for Rent:

Privacy Screen

ANNUAL EVENTS



Day of Remembrance - February

Honoring the past by educating and engaging the community through film screenings, lectures, and activities for our annual Day of Remembrance (observing the executive order that incarcerated Nikkei during WWII).



GVJCI Matsuri Fundraiser - June

This family-oriented festival is also our annual fundraiser and huge community event. There are games, foods, cultural arts, and performances all weekend long!



Tanoshii Fun Camp - July/August

A youth camp founded by retired teachers and community members, Tanoshii is a fun camp to make new friends and memories while experiencing hands-on Nikkei cultural traditions and activities!

ADDITIONAL EVENTS

Cultural Events and Programs

Mochitsuki (New Year's celebration and mochi-making), Hinamatsuri (Girl's Day), Kodomo No Hi (Children's Day), taiko, cultural, traditional, and culinary arts

Educational, Leadership, and Volunteer Programs

Japanese Language School, Adulting Workshops, technology classes, library, youth counselor training, service learning programs, community service projects, volunteer opportunities

Fundraiser Events

Annual raffle, Annual Signature Event, Elemental Funk Concert.

Arts, Music, and Dance

Performances and concerts, dance classes, writing workshops, art shows and displays, craft shows

Martial Arts and Sports

Judo, Karate, Kyudo (Archery), Naginata, Kendo, Shorinji Kempo, youth basketball and baseball organizations

Senior Programs

Classes, activities, workshops, Bento (lunch) program

Annual Events





READY TO JOIN THE FUN?

Connect with us through our website, social media, events and programs, or drop by our office to find out what's going on. There's something for everyone!

Donations help with funding and supporting the GVJCI programs and senior services that celebrate Japanese American heritage, youth & senior programs, facility maintenance, and everything in between. Donations are what keep us going! Ask us about:

Friend of the GVJCI Annual Giving Campaign
Volunteering
In-Kind Donations
Shop on Amazon Smile
Vehicle Donations
Matching Gifts



1964 W. 162nd Street
Gardena, CA 90247

www.jci-gardena.org

(310) 324-6611

info@jci-gardena.org

Office Hours:
Monday to Friday 9am to 5pm



@gardenavalleyjci



/GVJCI